

FILE NAME: V:\2002\active\2002005061\civil\drawing\sheet\Main Replacement\5061_C-WA-PLAN.dwg
 USER: Palmer, Logan
 PLOTTING DATE: 5/31/2017 10:31 AM

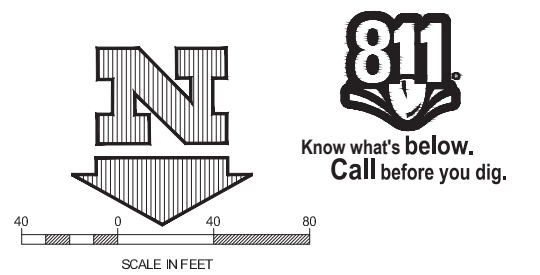
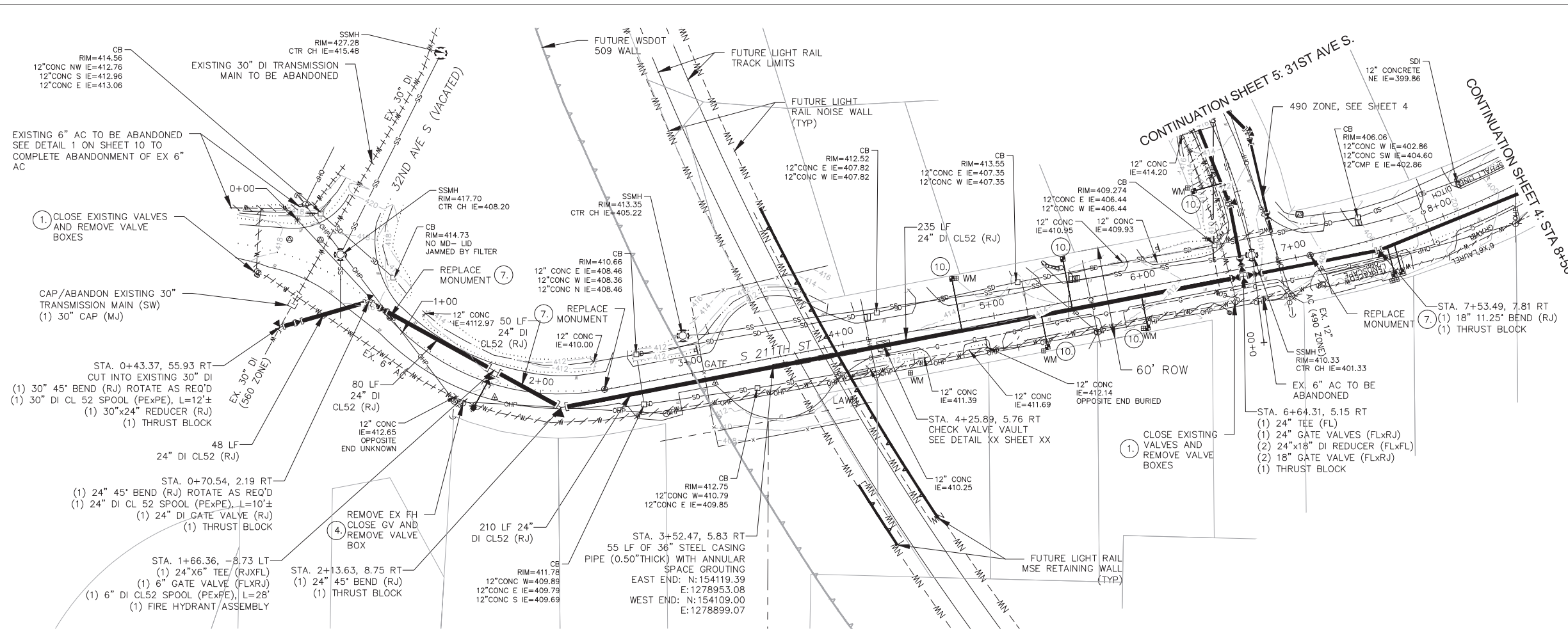

CONSTRUCTION NOTES

1. CLOSE VALVE, REMOVE VALVE BOX & SALVAGE MATERIALS TO HWD STORAGE YARD OR DISPOSE OF AT HWD'S DISCRETION. FILL VOID(S) WITH CDF AND REMOVE VALVE MARKER.
2. IF NEEDED, CAREFULLY REMOVE AND REINSTALL EXISTING MAILBOX(ES), AND/OR SIGNS, TYPICAL.
3. NOT USED.
4. REMOVE VALVE AND/OR HYDRANT. CONTRACTOR SHALL SALVAGE MATERIALS TO HWD'S STORAGE YARD OR DISPOSE OF THEM AT HWD'S DISCRETION.
5. MAINTAIN MINIMUM 18" VERTICAL SEPARATION FROM SANITARY SEWER, 12" FOR ALL OTHER CROSSINGS, UNLESS NOTED OTHERWISE ON THE PLANS.
6. CONNECTION ON BACKSIDE OF METERS TO CUSTOMER'S SIDE SHALL BE INCIDENTAL TO PROJECT COST(S), TYPICAL.
7. MONUMENTS TO BE DISTURBED/REMOVED SHALL BE REFERENCED WITH OFFSET STAKES PRIOR TO TRENCHING. CONTRACTOR TO PROVIDE ONE WEEK NOTICE FOR STAKING PRIOR TO DISTURBING MONUMENT.
8. NOT USED.
9. RECONNECT EX. 1" COPPER SERVICE. PAY ITEM SHALL BE PER SHORT SIDE SERVICE.
10. REPLACE EX. WATER SERVICE WITH NEW SERVICE PIPE AND METER BOX AS DETAILED IN STANDARD DETAIL NO. 21. ALL SERVICES SHOWN ARE TO BE 1" PIPE WITH 3/8" OR 3/4" METER UNLESS NOTED OTHERWISE. REMOVE AND DISPOSE OF OLD SERVICE BOX. INSTALL OR MAINTAIN REMOTE READ RADIO METERS AS DIRECTED BY THE DISTRICT AND AS DETAILED IN THE SPECIFICATIONS.
11. REPLACE EX. WATER SERVICE WITH NEW SERVICE PIPE AND METER BOX AS DETAILED IN STANDARD DETAIL NO. 22B FOR 1 1/2" SERVICE. SERVICES SHOWN ARE TO BE 2" PIPE WITH 1 1/2" METER AS NOTED. REMOVE AND DISPOSE OF OLD SERVICE BOX. INSTALL OR MAINTAIN REMOTE READ RADIO METERS AS DIRECTED BY THE DISTRICT AND AS DETAILED IN THE SPECIFICATIONS.
12. HORIZONTAL/VERTICAL PIPE DEFLECTION AS NECESSARY; HOWEVER, MAX. ALLOWABLE DEFLECTION FOR EACH JOINT SHALL NOT EXCEED ONE-HALF THE MANUFACTURER'S RECOMMENDED PERMISSIBLE DEFLECTION.
13. NOT USED.
14. POTHOLE EX. WATER TO VERIFY DEPTH AND LOCATION SUFFICIENTLY IN ADVANCE TO ACHIEVE VERTICAL ALIGNMENT.

UTILITY CONFLICT NOTE: CAUTION:

THE CONTRACTOR SHALL BE RESPONSIBLE FOR VERIFYING THE LOCATION, DIMENSION, AND DEPTH OF ALL EXISTING UTILITIES WHETHER SHOWN ON THIS PLAN OR NOT, BY POTHOLES THE UTILITIES AND SURVEYING THE HORIZONTAL AND VERTICAL LOCATION PRIOR TO CONSTRUCTION. THIS SHALL INCLUDE CALLING UTILITY LOCATIONS AT 811 AND THEN POTHOLES ALL OF THE EXISTING UTILITIES AT LOCATIONS OF NEW UTILITY CROSSINGS TO PHYSICALLY VERIFY WHETHER OR NOT CONFLICTS EXIST. IF CONFLICTS SHOULD OCCUR, THE CONTRACTOR SHALL CONSULT HIGHLINE WATER DISTRICT FOR DIRECTION PRIOR TO PROCEEDING WITH CONSTRUCTION.

PRELIMINARY

NO.	DATE	BY	APPR.	REVISION



HIGHLINE WATER DISTRICT
MANSION HILL 30" TRANSMISSION MAIN
REPLACEMENT AND WATER MAIN IMPROVEMENTS
S 211TH ST PLAN AND PROFILE

SHEET NO:
3
 DATE: SCALE: AS NOTED JOB # 2002005061
3 15